

TCXO GPS STO-2520A



Applications

- GPS

Features

- Small ceramic package / Dimensions (2.5 × 2.0 × 0.8)
- High stability ±0.5ppm / -30°C ~ +85°C
- Low current consumption
- Low phase noise
- Clipped sine output (DC coupled)

Specifications



| Model | | STO-2520A |
|---|---------------------------|--|
| Nominal frequency (MHz) | | 16,368, 16,369, 19.2, 23.104, 26, 27.456, 33.6, 38.4 MHz |
| Frequency stability | Tolerance at 25°C | ±2.0 × 10 ⁻⁶ (Sixty minutes after reflow) |
| | Temperature (+25°C basis) | ±0.5 × 10 ⁻⁶ / -30 ~ +85°C |
| | Supply voltage change | ±0.2 × 10 ⁻⁶ / V _{dd} ±5% |
| | Load change | ±0.2 × 10 ⁻⁶ / Z _L ±10% |
| Aging | | ±1.0 × 10 ⁻⁶ / First year |
| Storage temperature range | | -40 ~ +85°C |
| Power supply voltage (V _{cc}) | | +1.8V, +2.8V, +3.0V, +3.3V DC ±5% |
| Current consumption | | 2.0 mA max. |
| Output | Load (Z _L) | 10kΩ//10pF |
| | Voltage | 0.8V p-p min. |
| | Waveform | Clipped Sine Wave (DC-coupled output) |

*Reference / I_{dd} Spec

| Frequency stability [MHz] | Offset | at 10Hz | at 100Hz | at 1kHz | at 10kHz | Unit |
|---------------------------|-----------|----------------|------------|------------|------------|------|
| | | 16.368, 16.369 | -90(typ.) | -115(typ.) | -135(typ.) | |
| 26.000 | -70(typ.) | -105(typ.) | -130(typ.) | -145(typ.) | dBc/Hz | |

Package quantity: 1,000pcs max./Reel.

Outline and Dimensions [unit:mm]

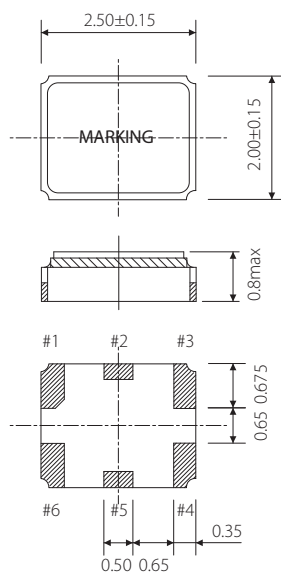

Example of a Terminal Land Pattern

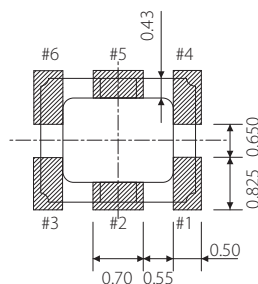

| Terminal | Connection |
|----------|-----------------|
| #1 | GND |
| #2 | N.C. |
| #3 | GND |
| #4 | OUTPUT |
| #5 | N.C. |
| #6 | V _{dd} |